

P85



BRIEF

An impressive ultralight Fuoriserie conceived to race and cruise

Designed to deliver a unique combination of performance and comfort, the new P85 superyacht is the product of a collaboration of excellence.

Yacht designer Mark Mills, Italian boatbuilder Persico Marine and renowned design house Pininfarina have teamed up to create a remarkably fast ultralight custom yacht.

The project concept has been developed for clients who want a sleek dual purpose craft: a reasonable-size performance sailing yacht that is easy to sail for fun with a limited crew, but, at the same time, ready to compete in the main events around the globe.

P85: sporty lines, comfort, light high-performance structure and fast.









YACHT CHARACTERISTICS

Hull

Construction: super lightweight material, the same used for the WallyCento (intermediate prepreg carbon sandwich with Kevlar Nomex honeycomb core, built in a female mould and oven postcured at 85°C).

Goal: high performance and superior quality.

Interior

Structure: superlight glass-carbon/Nomex honeycomb core sandwich panels, which can be customized with any kind of wooden veneer selected by the client.

Goal: a top-quality interior finish with the lowest possible weight.

Systems

Key concepts: retractable propeller, lifting keel, three spreader rigs with running backstays and a square top mainsail. Light displacement of around 30T, allowing for hull planing in certain conditions.

Goal: one of the fastest yachts of any size.

P85 main preliminary characteristics

Length	25.74 m - 85 ft
Beam	6.50 m - 21.3 ft
Draft	4.0m/6.0m - 13.1/19.7 ft (lifting) 5.00 m - 16.4 ft (fixed)
Dspl	29T (light ship)
Sailplan Area	376 m ²





PERFORMANCE DATA

HPDS 85 VMG SPM				
Wind	upwind	reacher 80°	reacher 120°	downwind
6	795.2	368.7	387.7	626.5
8	603.8	303.8	311.4	487.8
10	504.1	269.0	272.8	412.1
12	450.2	246.3	245.9	360.9
14	418.0	229.9	224.9	323.6
16	396.6	215.4	205.0	291.7
18	382.4	204.2	194.9	259.4
20	372.4	197.1	188.7	236.6
Compare [sec/ml]				

HPDS 85 VMG Kn			
upwind	reacher 80°	reacher 120°	downwind
4.5	9.8	9.3	5.7
6.0	11.9	11.6	7.4
7.1	13.4	13.2	8.7
8.0	14.6	14.6	10.0
8.6	15.7	16.0	11.1
9.1	16.7	17.6	12.3
9.4	17.6	18.5	13.9
9.7	18.3	19.1	15.2
Compare [sec/ml]			

HPDS 85 Vs SPM				
Wind	upwind	reacher 80°	reacher 120°	downwind
6	546.9	368.7	387.7	435.7
8	432.6	303.8	311.4	363.4
10	372.5	269.0	272.8	332.1
12	341.1	246.3	245.9	300.3
14	321.7	229.9	224.9	268.1
16	307.8	215.4	205.0	235.6
18	298.8	204.2	194.9	206.9
20	287.3	197.1	188.7	196.2
Compare [sec/ml]				

HPDS 85 Vs Kn			
upwind	reacher 80°	reacher 120°	downwind
6.6	9.8	9.3	8.3
8.3	11.9	11.6	9.9
9.7	13.4	13.2	10.8
10.6	14.6	14.6	12.0
11.2	15.7	16.0	13.4
11.7	16.7	17.6	15.3
12.0	17.6	18.5	17.4
12.5	18.3	19.1	18.4
Compare [sec/ml]			

INTERIORS ARRANGEMENT

The P85 is designed to be comfortable for sport cruising. The interior layout concept is a large central community area featuring an open-plan galley/saloon with a double sofa. In addition to the large-size owner's front cabin, there will be two aft guest cabins port and starboard with dedicated heads and showers, as well as crew quarters in the foredeck area.

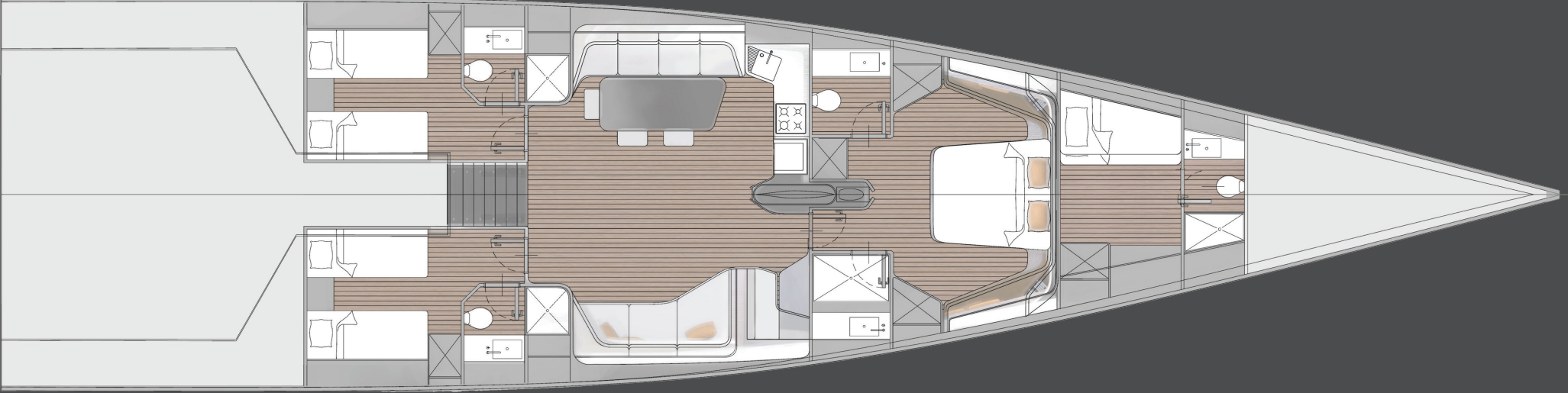

INTERIORS INSPIRATION









INTERIORS



BUILDING TEAM



PERSICO MARINE

Persico Marine builds custom sailing yachts for the world's most renowned racing teams and private owners.

The Italian boatbuilder has worked on racing yachts for the America's Cup, the Volvo Ocean Race, the mini maxi 72 class and many others. In the performance sailing yacht sector, Persico is currently working on Frers' Wally 100 and has recently collaborated with the Nobiskrug yard.

Persico is highly regarded as a skilled, full-service supplier, always ready to share its technological know-how with its clients.

PERFORMANCE

"At Persico we focus on performance and use the most advanced technology to develop faster high-quality yachts."

Marcello Persico
CEO of Persico Marine





MILLS DESIGN

Ireland-based Mills Design is one of the most successful yacht design firms in the world. In addition to winning numerous races worldwidesince the first design in 1996, Mills' yachts have garnered Boat of the Year awards. Mills is known for its focal design concept – concentrating on function, aesthetics and speed – and its excellent results.

BEAUTY

"Speed is tested on the day, but beauty is forever. We aim to make fast boats visually stunning by matching the look with the character of the project".

Mark Mills

Founder of Mills Design



PININFARINA

Pininfarina is an internationally renowned design house, with offices in Italy, Germany, China and the United States. For 85 years it has been recognized as the hallmark of Italian style and the creator of masterpieces for prestigious brands such as Ferrari, Alfa Romeo, Maserati and BMW.

TAILOR-MADE

"Our philosophy is to conceive tailor-made projects, designing every single detail with the aim of fulfilling the need and the dreams of the customer".

Paolo Pininfarina
Chairman of Pininfarina



